

IGT201

IGB3012-APKG/MV4A/US-104-DPO

Inductive sensors

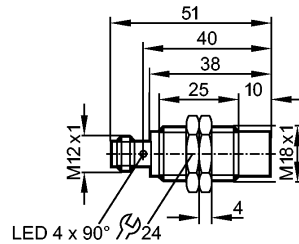

Made in Germany



Product characteristics

| |
|---|
| Inductive sensor |
| Metal thread M18 x 1 |
| Connector |
| Increased sensing range |
| Gold-plated contacts |
| Sensing range 12 mm; [nf] non-flush mountable |

Electrical data

| | |
|-----------------------------|-------------|
| Electrical design | DC PNP |
| Operating voltage [V] | 10...36 DC |
| Current consumption [mA] | < 10 (24 V) |
| Protection class | II |
| Reverse polarity protection | yes |

Outputs

| | |
|--------------------------|-----------------|
| Output function | Normally closed |
| Voltage drop [V] | < 2.5 |
| Current rating [mA] | 100 |
| Short-circuit protection | pulsed |
| Overload protection | yes |
| Switching frequency [Hz] | 300 |

Range

| | |
|------------------------------|-----------|
| Sensing range [mm] | 12 |
| Real sensing range (Sr) [mm] | 12 ± 10 % |
| Operating distance [mm] | 0...9.7 |

Accuracy / deviations

| | |
|------------------------------|--|
| Correction factors | mild steel = 1 / stainless steel approx. 0.7 / brass approx. 0.5 / Al approx. 0.4 / Cu approx. 0.3 |
| Hysteresis [% of Sr] | 1...20 |
| Switch-point drift [% of Sr] | -10...10 |

Environment

| | |
|--------------------------|-----------------------|
| Ambient temperature [°C] | 0...100 |
| Protection | IP 68 / IP 69K; "COP" |

Tests / approvals

| | |
|-----|--|
| EMC | EN 61000-4-2 ESD: 4 kV CD / 8 kV AD |
| | EN 61000-4-3 HF radiated: 10 V/m (80...1000 MHz) |
| | EN 61000-4-4 Burst: 2 kV |
| | EN 61000-4-6 HF conducted: 10 V (0.15...80 MHz) |
| | EN 55011: class B |

IGT201

IGB3012-APKG/MV4A/US-104-DPO

Inductive sensors

| | | |
|------|---------|------|
| MTTF | [Years] | 1925 |
|------|---------|------|

Mechanical data

| | | |
|-------------------|--|-------|
| Mounting | non-flush mountable | |
| Housing materials | stainless steel (316L); active face: PEEK (polyether ether ketone) | |
| Weight | [kg] | 0.046 |

Displays / operating elements

| | | |
|--------------------------|-----|------------------|
| Output status indication | LED | yellow (4 x 90°) |
|--------------------------|-----|------------------|

Electrical connection

| | | |
|------------|-------------------------------------|--|
| Connection | M12 connector; Gold-plated contacts | |
|------------|-------------------------------------|--|

Wiring

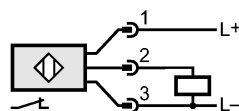

Accessories

| | | |
|------------------------|-------------|--|
| Accessories (included) | 2 lock nuts | |
|------------------------|-------------|--|

Remarks

| | | |
|---------------|---------|---|
| Pack quantity | [piece] | 1 |
|---------------|---------|---|