

**MFS209**

MFK3060-ANKG/AM/G/US

Magnetic sensors, cylinder sensors

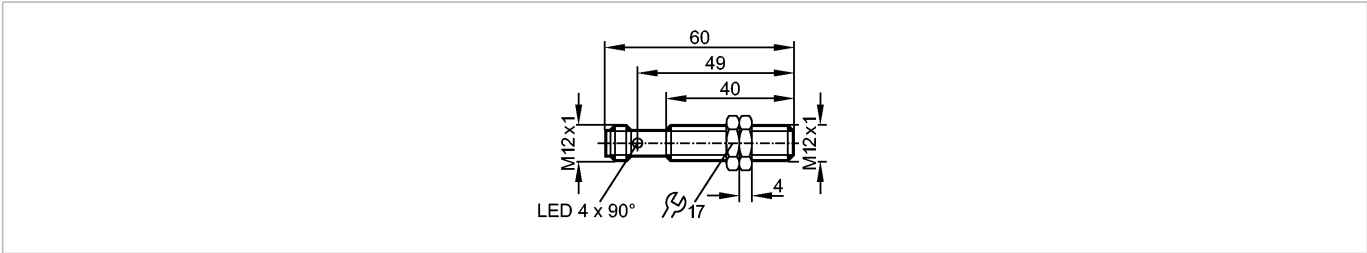

Made in Germany

**Product characteristics**

Magnetic sensor with GMR cell
Metal thread M12 x 1
Connector
Full metal housing
gold-plated contacts
Sensing range 60 mm; referred to magnet M4.0
Magnetic sensitivity 1.3 mT

**Electrical data**

Electrical design	DC NPN
Operating voltage [V]	10...30 DC
Current consumption [mA]	< 10
Protection class	III
Reverse polarity protection	yes

**Outputs**

Output function	normally open
Voltage drop [V]	< 2.5
Current rating [mA]	200
Short-circuit protection	yes
Overload protection	yes
Switching frequency [Hz]	5000

**Range**

Sensing range [mm]	60, referred to magnet M4.0
Magnetic sensitivity [mT]	1.3

**Accuracy / deviations**

Hysteresis [% of Sr]	1...10
----------------------	--------

**Environment**

Ambient temperature [°C]	-25...75
Protection	IP 65 / IP 67

**Tests / approvals**

EMC	EN 61000-4-2 ESD: 4 kV CD / 8 kV AD
	EN 61000-4-3 HF radiated: 100 V/m (80...2000 MHz)
	EN 61000-4-4 Burst: 2 kV
	EN 61000-4-5 Surge: 0.5 kV (line to line, Ri: 20hm)
	EN 61000-4-6 HF conducted: 10 V (0.15...80 MHz)
	EN 55011 (Emission): class B
	DIN ISO 7637-2: 100 V/m

**Mechanical data**

**MFS209**

MFK3060-ANKG/AM/G/US

**Magnetic sensors, cylinder sensors**

Housing materials	housing: stainless steel (316L); active face: stainless steel (316L); connector: PA (polyamide); lock nuts: brass
-------------------	---

Weight	[kg]	0.027
--------	------	-------

**Displays / operating elements**

Output status indication	LED	yellow (4 x 90°)
--------------------------	-----	------------------

**Electrical connection**

Connection	M12 connector; gold-plated contacts
------------	-------------------------------------

**Wiring**

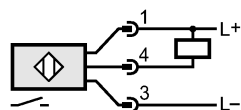

**Accessories**

Accessories (included)	2 lock nuts
------------------------	-------------

**Remarks**

Pack quantity	[piece]	1
---------------	---------	---