

O6S301

O6S-00KG/0.30m/US

Photoelectric sensors

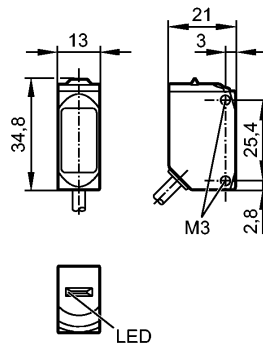

Made in Germany



Product characteristics

Through-beam sensor
Rectangular Metal
Cable with connector
Transmitter
Sensing range 10m

Electrical data

Electrical design	DC
Operating voltage [V]	10...30 DC
Current consumption [mA]	20 (24 V)
Type of light	Red light 633 nm
Protection class	III

Range

Sensing range [m]	10
Light spot diameter [mm]	300 (at maximum range)

Excess gain graphs

x: distance in [mm]
y: excess gain factor

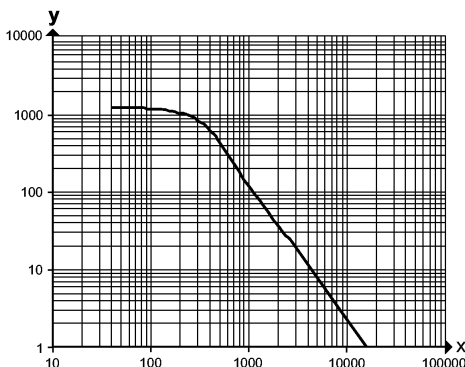

Environment

Ambient temperature [°C]	-25...80
Protection	IP 65 / IP 67 ; IP 68 / IP 69K

Tests / approvals

EMC	EN 60947-5-2
MTTF [Years]	2600
UL approval number	E005

Mechanical data

O6S301

O6S-00KG/0.30m/US

Photoelectric sensors

Housing materials	housing: stainless steel 316L / 1.4404; plastics: PPSU
Lens material	PMMA
Weight [kg]	0.053

Displays / operating elements

Operation	LED	green
-----------	-----	-------

Electrical connection

Connection	PVC cable / 0.3 m; 4 x 0.25 mm ² ; with M12 connector
------------	--

Wiring

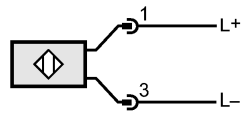

Remarks

Remarks	UL - Class 2 source required
Pack quantity [piece]	1